

**CO-200 Casement**

**CI-200 Casement**

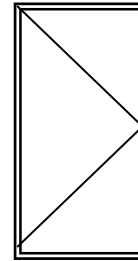

CO-200  
Out-swing

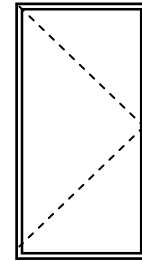

CI-200  
In-swing

**Side Hung Thermally Broken Extruded Aluminum Window**

**CO-200 Projects Out**  
**CI-200 Projects In**

Profiles available:

- ❖ Flush
- ❖ Classic

**Features:**

- ❑ Tested to the performance requirements outlined in CAN/CSA-A440
- ❑ Air Tightness A3
- ❑ Water Tightness B6
- ❑ Wind Load resistance C5
- ❑ Condensation Resistance I = 51
- ❑ 2" Industry standard frame depth
- ❑ Extruded aluminum drip deflector.
- ❑ Continuously crimped-in-place rigid thermal break
- ❑ Corner joints back sealed for weatherproofing and resistance to the elements.
- ❑ Glazing Options : 1"- 1 3/4"
- ❑ Adaptable to meet you hardware requirements
- ❑ Glazing stops utilizing a soft-rubber bulb-type spline providing more than adequate glazing compression.
- ❑ Optional CO 200 interior insect screens or exterior on the CI 200
- ❑ Option for split finish as per requirements.
- ❑ Easily inserted into Curtain Wall systems to allow ventilation.

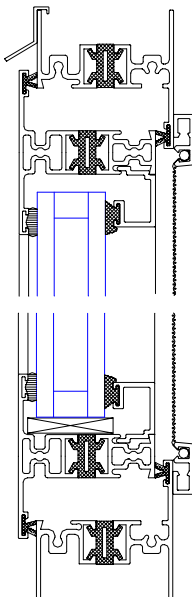

Flush Profile