

HS-400 Series

Horizontal Sliding Window

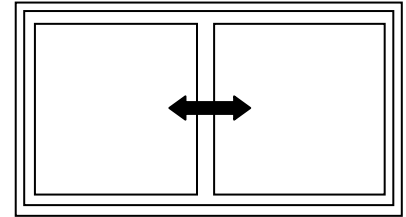

Thermally Broken Horizontal Sliding Window

Features:

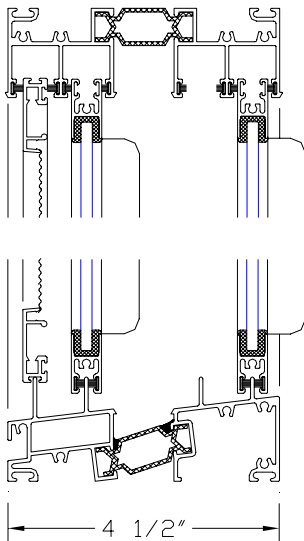

- ❑ Tested to the performance requirements outlined in CAN/CSA-A440.
- ❑ Frame depth 4 1/2".
- ❑ Four independent operating sashes.
- ❑ Corner joints back sealed for maximum resistance to the elements.
- ❑ Glazing Options : 3mm – 6mm
- ❑ Dual seals on sash perimeter.
- ❑ Optional interior or exterior insect screen with mitered corners.
- ❑ Option for split finish as per requirements.
- ❑ Sash glides for ease of operation.
- ❑ Sloped sill construction providing optimized draining.
- ❑ Sash limiting option available.
- ❑ Extruded sash locks with one spring loaded extruded keeper-type lock at mid-span of sash.
- ❑ Adaptable with interlocking panning and trim.