

VI -200 Hopper

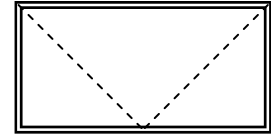

Thermally Broken Extruded Aluminum Bottom-Hung Projecting In Window

Profiles available:

- ❖ Flush
- ❖ Classic

Features:

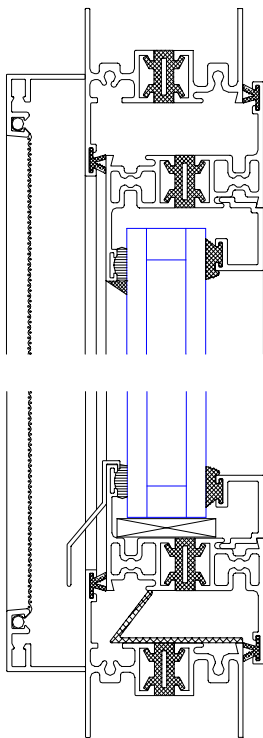

Flush Profile

- ❑ Tested to the performance requirements outlined in CAN/CSA-A440
- ❑ Air Tightness A3
- ❑ Water Tightness B7
- ❑ Wind Load resistance C5
- ❑ Condensation Resistance I = 55
- ❑ 2" Industry standard frame depth
- ❑ Extruded aluminum drip deflector.
- ❑ Continuously crimped-in-place rigid thermal break
- ❑ Corner joints back sealed for weatherproofing and resistance to the elements.
- ❑ Glazing Options : 1" - 1 3/4"
- ❑ Both jambs feature a mechanically fastened steel concealed 4 bar hinge assembly for ideal weight distribution.
- ❑ Dual seals on head, jambs, & sill of sash perimeter
- ❑ Glazing stops utilizing a soft-rubber bulb-type spline providing more than adequate glazing compression.
- ❑ Optional exterior insect screen with mitered corners, and supported in place with mechanically fastened cast metal swing clips.
- ❑ Option for split finish as per requirements.
- ❑ Easily inserted into Curtain Wall systems to allow ventilation