

VI -300 Hopper Window

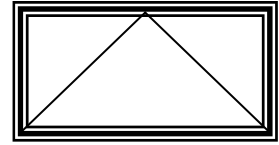

Thermally Broken Extruded Aluminum Bottom-Hung Project Inward Window

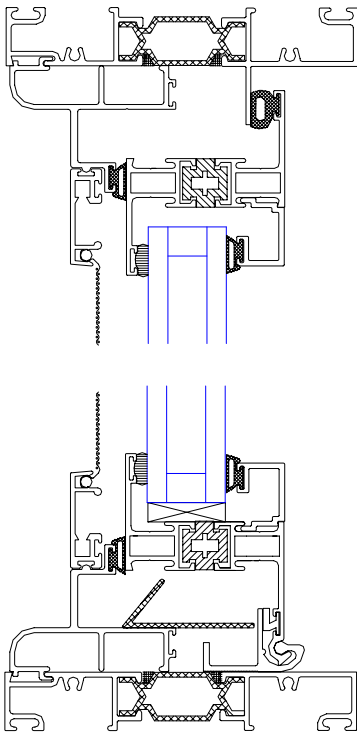

300 series shown in combination with Alwinds 400 series fixed 4 1/2" frame.

Alwind's revolutionary patented continuous aluminum extruded hinge for even sash weight distribution and longevity for hard-wear and tear usage in schools and institutional buildings.

Features:

- ❑ 3" industry standard inserts into any standard Alwind fixed frame system.
- ❑ Crimped-in-place rigid PVC thermal break
- ❑ Corner joints back-sealed for weatherproofing and increased resistance to the elements.
- ❑ Meets and exceeds CAN3-A440-M84 Standards as outlined in the Canadian Window Standard.
- ❑ Double weather seal on head, jambs, sill of operable members
- ❑ Interior glazing utilizing a soft-rubber bulb-type glazing spline for adequate glazing compression.
- ❑ Exterior Flush Mount Fiberglass fly-screens with mitered corners
- ❑ Friction fit screens eliminate the use of unsightly fasteners on the exterior.
- ❑ Baked on enamel or anodized finishes as per requirements.
- ❑ Optional finishes interior and exterior.